

MOUNTING HOLE

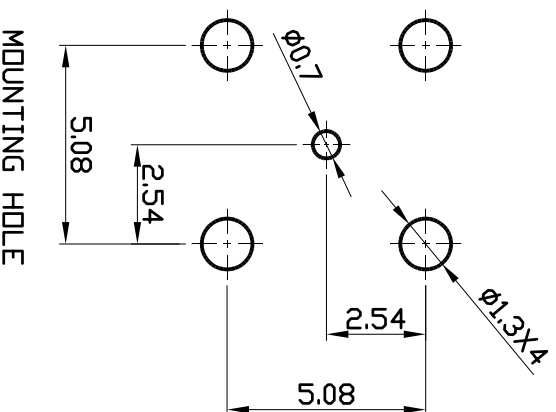

MOUNTING HOLE

NOTES: FINISH (PLATING THICKNESS IN MICRO-INCHES)

1. BRASS PER JIS H3250 C3604BD.
2. INSULATOR: PTFE ASTM-D-1457.

3. GOLD PL. 5 MIN. OVER NICKEL PL. 50 MIN. OVER COPPER PL. 50 MIN.
4. GOLD PL. 15 MIN. OVER NICKEL PL. 50 MIN. OVER COPPER PL. 50 MIN.

| NO. | DESCRIPTION  | MATERIAL | FINISH | QTY | PART NO.     |
|-----|--------------|----------|--------|-----|--------------|
| 8   | HEX NUT      | NOTE 1   | NOTE 3 | 1   | SMB45-5      |
| 7   | LOCK WASSHER | NOTE 1   | NOTE 3 | 1   | SMB45-4      |
| 6   | COVER        | NOTE 1   | NOTE 3 | 1   | MCX11-316L-5 |
| 5   | CONTACT PIN  | NOTE 1   | NOTE 4 | 1   | SMB49-75L-5  |
| 4   | CONTACT PIN  | NOTE 1   | NOTE 4 | 1   | SMB49-75L-4  |
| 3   | INSULATOR    | NOTE 2   |        | 1   | SMB49-75L-3  |
| 2   | INSULATOR    | NOTE 2   |        | 1   | SMB49-75L-2  |
| 1   | BODY         | NOTE 1   | NOTE 3 | 1   | SMB49-75L-1  |

DIMENSION ARE MILLIMETERS  
UNLESS OTHERWISE SPECIFIED  
TOLERANCES  
1-10 = ±0.2  
10-30 = ±0.4  
30-200 = ±1.5  
200-1000 = ±10  
1000-~ = ±25

| SCALE | REV | UNIT |
|-------|-----|------|
| 5 / 1 | -   | M/M  |

TITLE  
SMB R/A JACK P.C.B. MOUNT

DRAWING NO.  
SMB49-75L

科曼實業有限公司  
**interconn enterprise**

CHECKED  
DATE: 07/11/2007

DRAWN  
DATE: 07/11/2007